

**READ THIS FIRST AND STORE PROPERLY FOR FUTURE USE!**

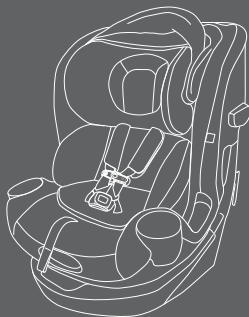

# **CALLISTO G 360**

Owner's Manual

## Table of Contents

**READ this Owner's Manual carefully before first use and store it for future reference in the compartment on the back of the seat shell (see pg. 28).**

Introduction.....	4-5
Registration/Recall Information .....	6
Certification.....	7
Child Usage Guidelines .....	8-12
Warnings .....	13-26
Overview of the Callisto G 360 .....	27-29
Product Features	
Adjustable Buckle Strap .....	30
Cup Holders.....	31-32
Harness Adjustment .....	33
Harness Buckles.....	33
Infant Insert.....	34
Lower Anchors .....	35-36
No Rethread Harness and Headrest Adjustment .....	37-38
Removable Canopy .....	38
Seat Rotation and Recline.....	39-40
SensorSafe Chest Clip .....	41
Shoulder Pads .....	42
Tether Strap.....	43

## Table of Contents

Installing the Callisto G 360	
Installation with Lap/Shoulder Belt (Preferred Method) .....	44-48
Installation with Lower Anchors .....	49-52
Installation with Lap Belt Only .....	53-56
Removing the Child Restraint from the Vehicle .....	57
Using Callisto G 360 in Booster Mode.....	58-60
Securing the Child with Harness .....	61-67
Removing and Replacing Seat Cover .....	68-71
Installing Callisto G 360 in an Aircraft.....	72-74
Care and Cleaning.....	75
Safety Checklist.....	76
Helpful Tips.....	77
Resources .....	78
Warranty .....	79-80

Welcome to CYBEX! We're thrilled you chose the Callisto G 360. Crafted with German engineering excellence, this product is now available in the United States. We are confident it will provide safer, more comfortable travel for your child and make installation and use effortless for you.

**According to the U.S. National Highway Traffic Safety Administration (NHTSA), car seats and Boosters provide protection for infants and children in a crash, yet car crashes are a leading cause of death for children.**

**Statistics show that over 75% of Child Restraints are being used incorrectly!**

Please read and follow these instructions carefully to install the CYBEX Callisto G 360 correctly, even if the installation and use of this Child Restraint might seem simple and intuitive. Before the first use of this Child Restraint, please make sure you have completed all the steps in the Safety Checklist on pg. 75.

Following the American Academy of Pediatrics' recommendations for safe transportation of infants, **we recommend children remain in a REAR-FACING car seat as long as possible, until they reach the highest weight or height allowed by their seat.** Visit [www.aap.org](http://www.aap.org) for more information on the Academy's recommendation.

No Child Restraint can guarantee protection from injury in every situation, but proper use helps reduce the risk of death or serious injury. If you have any questions or need assistance, please contact CYBEX Consumer Services at 1-877-242-5676.

Also, please remember to register your Child Restraint so we can contact you in the unlikely event of a recall. Register online at <https://register.cybex-online.com/us/carseats>

Keep this Owner's Manual for future reference by storing it in the compartment on the back of the Child Restraint as shown on pg. 28. We appreciate your purchase and invite you to visit [www.cybex-online.com](http://www.cybex-online.com) to see other great CYBEX products.

For step-by-step installation video, scan this QR Code:



For Frequently Asked Questions, scan this QR Code:



## Registration/Recall Information

**Please complete the registration card that came with your Child Restraint and mail it in immediately or register online.**

Child Restraints could be recalled for safety reasons. You must register this restraint to be reached in a recall. Send your name, address, phone number, e-mail address (if available), and the restraint's model number and manufacturing date to:

**Columbus Trading-Partners USA Inc.**  
**Attn: CYBEX Consumer Services**  
**2915 Whitehall Park Drive, Suite 300**  
**Charlotte, NC 28273, USA**

You may also call CYBEX Consumer Services at 1-877-242-5676, or register online at <https://register.cybex-online.com/us/carseats>

**For recall information**, call the U.S. Government's Vehicle Safety Hotline at 1-888-327-4236 (TTY: 1-800-424-9153), or go to [www.NHTSA.gov](http://www.NHTSA.gov)

## Certification

**Regulatory Notice:** This Child Restraint system meets all applicable requirements of Federal Motor Vehicle Safety Standard (FMVSS) 213b.

### **THIS RESTRAINT IS CERTIFIED FOR USE IN AIRCRAFT.**



When used **WITH** the internal harness and properly installed pursuant to these instructions, **this restraint is certified for use only in passenger and multipurpose passenger motor vehicles, buses and trucks equipped with Lap Belts only, Lap/Shoulder Belts, or Lower Anchors, and for use in aircraft.**

Check with your airline before departure to make sure this restraint meets all requirements, then refer to pgs. 72-74 for aircraft installation instructions. **This seat can not be used with an inflatable seat belt.**

When used **WITHOUT** the internal harness system in **BOOSTER MODE** and properly installed pursuant to these instructions, **this restraint is certified for use only in passenger and multi-purpose passenger motor vehicles, buses, and trucks equipped with Lap/Shoulder Belt systems only.**

When used in **BOOSTER MODE**, **this restraint is NOT certified for use in aircraft. A belt-positioning booster requires the use of a Lap/Shoulder Belt system, which is not available in aircraft.**

The American Academy of Pediatrics (AAP) recommends keeping children **REAR-FACING** for as long as possible, until they reach the maximum height or weight for their Child Restraint in **REAR-FACING** orientation.

Additionally, some states' laws require children to be **REAR-FACING** until age 2. Accordingly, you will see this guidance reflected in the Child Requirements on the following pages. Please review any applicable local or state laws related to child passenger safety before installing and using this Child Restraint.

[Pediatrics. 2018;142(4):e20182460]

### Premature Infant Use

**Before using this Child Restraint for preterm or low birth weight infants, ensure the Child Requirements are met and follow the guidelines in this section.**

According to the National Highway Traffic Safety Administration (NHTSA), a properly installed Child Restraint reduces the risk of death by over 70% for infants involved in crashes. Federal Motor Vehicle Safety Standard (FMVSS) 213b establishes design and dynamic performance requirements for Child Restraint systems. However, the standard has no minimum weight limit and does not address the special medical needs of preterm or low birth weight infants.

To ensure that preterm and low birth weight infants are transported safely, the guidelines published by the American Academy of Pediatrics (AAP) in Pediatrics 2009;123:1424–1429 (reaffirmed June 2018) must be followed.

Preterm and low birth weight infants are at additional risk of breathing difficulties and heart problems when placed in a Child Restraint. CYBEX requires that the evaluation recommended by the AAP be conducted for all infants born earlier than 37 weeks and all newborn infants who weigh less than 5 lb (2.26 kg) at birth before their first car trip to check for breathing difficulties or heart rate problems when traveling in a **REAR-FACING** Child Restraint. Newborn infants should **NEVER** travel in a **FORWARD-FACING** Child Restraint.

The AAP recommends that appropriate hospital staff observe your infant in the Child Restraint for a period of 90 to 120 minutes or the duration of travel, whichever is longer. This period of observation must be performed with the infant properly positioned as described in these instructions and with the Child Restraint placed at an angle that is approved for use in the vehicle. The hospital staff will check for any breathing difficulties or heart rate problems. Your child's pediatrician will let you know if there are any special considerations for travel. The number of trips and the duration of time the infant is seated in the Child Restraint should be minimized. A caregiver should ride in the back seat to monitor the infant during travel.

You can learn more about the AAP's recommendations as well as other resources for parents and medical professionals at <https://www.healthychildren.org/english/safety-prevention/on-the-go/Pages/default.aspx>

## Child Usage Guidelines

For **REAR-FACING MODE**, your child **MUST** meet all the requirements listed:

- Weight is between 4 and 40 lb (1.8 and 18.2 kg).
- Height is below 43.3 inches (110 cm).
- Child's head **MUST** be 1 inch (2.5 cm) or more **BELOW** the top of the shell **A** or the top of the Headrest **B**, whichever is higher.
- Harness straps must be adjusted to be **AT or JUST BELOW** the child's shoulders **C**.

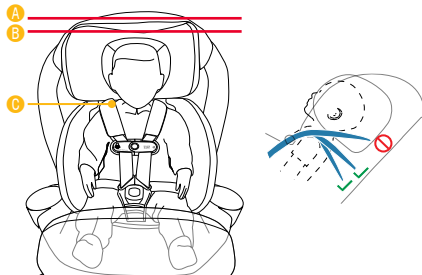

If the child does **NOT** meet these requirements because they are:

- a. **too small**, select a different Child Restraint (such as a **REAR-FACING ONLY** infant car seat).
- b. **too large**, review **FORWARD-FACING** guidelines on pg. 10 to determine if this Child Restraint may be used.

**IMPORTANT: DO NOT** use Lower Anchors in **REAR-FACING MODE** if child weighs more than 30 lb (13.6 kg).

Recline the seat to the appropriate position based on your child's weight.



The Recline Indicator Arrow **MUST** be aligned within the correct recline zone for proper use.

See "Helpful Tips" on pg. 77.

## Child Usage Guidelines

For **FORWARD-FACING MODE**, your child **MUST** meet all the requirements listed:

- Weight is between 26.5 and 65 lb (12 and 29.5 kg).
- Height is between 34.3 and 49.2 inches (87 and 125 cm).
- Top of child's ears **BELOW** the top of the Headrest **A**.
- At least 1 year old
- Harness straps must be adjusted to be **AT or JUST ABOVE** child's shoulders **B**.

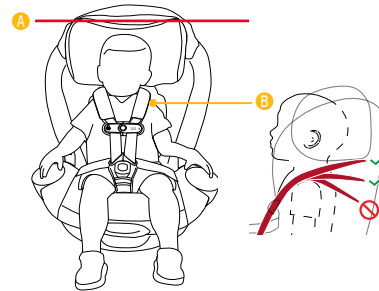

If the child does **NOT** meet these requirements because they are:

- a. **too small**, review the **REAR-FACING** guidelines (see pg. 9) to determine if this Child Restraint may be used.
- b. **too large**, review the **BOOSTER MODE** guidelines on pg. 12.

Recline the seat to the appropriate position based on your child's weight (see pg. 10).

**IMPORTANT: DO NOT** use Lower Anchors in **FORWARD-FACING MODE** if child weighs more than 35 lb (15.9 kg).

## Child Usage Guidelines

For **BOOSTER MODE**, your child **MUST** meet all the requirements listed:

- Weight is between 40 and 120 lb (18.2 and 54.4 kg).
- Height is between 43.3 and 57 inches (110 and 145 cm).
- Top of child's ears **BELOW** the top of the Headrest.
- 4 years of age or older
- The Shoulder Belt **MUST** pass through the Shoulder Belt Path and should be **AT** or **JUST ABOVE** the shoulders.
- The Shoulder Belt **MUST** cross midway between the child's shoulder and neck.
- The Lap Belt is stretched low and snug across the child's hips within the Lower Belt Path and fastened into the buckle.

If the child does **NOT** meet these requirements because they are:

- a. **too small**, review the **REAR-FACING** and **FORWARD-FACING** guidelines to determine if this Child Restraint may be used.
- b. **too large**, discontinue use of this seat. Your child may be ready to use the vehicle belt system only at this time.

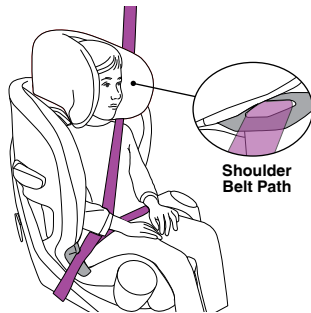

**ONLY** use Lower Anchors in **BOOSTER MODE** to secure the Booster seat to the vehicle seat. The vehicle Lap/Shoulder Belt is required to secure the child in the Booster seat.

**DO NOT** use Canopy in **BOOSTER MODE**.

## **⚠ WARNING!** DEATH or SERIOUS INJURY can occur.

- **READ** this Owner's Manual carefully before first use and keep it for future reference.
- **FOLLOW ALL INSTRUCTIONS** on this Child Restraint and in the written instructions in the compartment on the back of the Child Restraint.

### Airbag Warnings

- **DO NOT** place a **REAR-FACING** Child Restraint on a front seat with an active airbag. **DEATH or SERIOUS INJURY can occur.** The back seat is the safest place for children 12 and under.
- **DO NOT** use this Restraint in the front seat of a vehicle equipped with an air bag. Interaction between a **REAR-FACING** Child Restraint and air bags may cause death or serious



injury. If your vehicle has an air bag, refer to the vehicle Owner's Manual for Child Restraint installation.

- **DO NOT** use this Child Restraint in a vehicle seating position equipped with a side air bag unless allowed by the vehicle manufacturer. Refer to vehicle Owner's Manual.
- **DO NOT** place any objects between the Restraint and the side air bag, as an expanding air bag may cause the items to strike your child.

### General Warnings

- The primary protection for occupants of a vehicle in a collision is the structure of the vehicle itself.
- This child restraint will substantially improve the chances for survival in most crashes if correctly used per the instructions and labeling.

## **WARNING!** DEATH or SERIOUS INJURY can occur.

- **NEVER** install or use this Child Restraint until you have read and understand the instructions in this manual, your vehicle Owner's Manual, and the labels on your Child Restraint.

If there is a conflict between this manual and the vehicle Owner's Manual, contact CYBEX Consumer Services at 1-877-242-5676. Failure to follow these instructions can result in death or serious injury to your child in a crash.

- **DO NOT** allow others to install or use this Child Restraint unless they understand how to correctly install and use it.
- **NEVER** allow someone else to use this Child Restraint without also passing along this manual to them.
- **DO NOT** use a Child Restraint with an unknown history.
- **NEVER USE CHILD RESTRAINT IF IT HAS DAMAGED, BROKEN, OR MISSING PARTS.**
- **DO NOT** attempt to make repairs to or otherwise modify or tamper with this Child Restraint.
- **ALWAYS REPLACE THE CHILD RESTRAINT AFTER A CRASH OF ANY KIND, EVEN IF IT WAS UNOCCUPIED.** A crash can cause damage to the Child Restraint that may not be visible.
- **BEFORE** each use, **ALWAYS CHECK** that the Child Restraint is tightly secured in the vehicle seat and does not move more than 1 inch (2.5 cm) in any direction when checked at the Belt Path. If you cannot tightly

## **WARNING!** DEATH or SERIOUS INJURY can occur.

secure the Child Restraint, try again or move it to another location.

- **ALWAYS** check Buckles and other parts for hot surfaces before placing your child in the Child Restraint. A hot surface could burn your child! Cover an unoccupied Child Restraint with a blanket when leaving it in a vehicle. The interior of a vehicle can become hot enough to burn child even on a cloudy day.
- **NEVER** leave an empty Child Restraint unsecured in your vehicle. This restraint must always be secured, **even when not occupied.** An unsecured Child Restraint could injure vehicle occupants in a sudden stop or crash.
- **NEVER** leave an empty Child Restraint in the load/unload position.

The restraint must always be rotated and locked either **REAR-FACING** or **FORWARD-FACING**, **even when not occupied.**

- This product contains magnets, which may present a swallowing hazard. **Seek immediate medical attention if magnet(s) are swallowed or inhaled.** Before use, consult your family doctor about the compatibility of this product with pacemakers and similar devices.
- The Headrest on the vehicle seat that the child faces should be placed in the lowest position. Vehicle seats are regulated by Federal Motor Vehicle Safety Standards. The seat back that the child faces must not be altered in any way. **DO NOT** attach or hang additional items from the vehicle seat back that are not approved by



## **⚠ WARNING!** DEATH or SERIOUS INJURY can occur.

the vehicle manufacturer. Items not tested with the vehicle seat could injure the child or interfere with car seat performance.

See "Helpful Tips" on pg. 77.

### Location Warnings

- **ACCORDING TO ACCIDENT STATISTICS**, children are safer when properly restrained in rear vehicle seating positions.
- **ONLY** place this Child Restraint in a vehicle seating location allowed by the vehicle manufacturer. To determine allowable seating positions, refer to your vehicle Owner's Manual for information about vehicle seat belt systems, air bags, side air bags, front passenger side air bags and Child Restraint installations.
- **NOT EVERY LOCATION WITHIN A VEHICLE MAY BE SAFE FOR THE INSTALLATION OF THIS CHILD RESTRAINT.** In fact, some vehicles have no seating position that is safe for the installation of this Child Restraint. Improper placement of this Child Restraint within a vehicle will increase the risk of death or serious injury.
- **DO NOT** use this Child Restraint in vehicles that do not have vehicle seat belts or lower anchors (pgs. 21-26).
- **NEVER** use this Child Restraint in a vehicle seating position where it cannot be secured tightly. A loosely installed Child Restraint will not protect your child in a crash.
- **ONLY** use this Child Restraint on vehicle seats with backs that lock into

## **⚠ WARNING!** DEATH or SERIOUS INJURY can occur.

place. In the event of a sudden stop, an unlocked vehicle seat back could prevent this Child Restraint from protecting your child.

- **ONLY** use this Child Restraint on **FORWARD-FACING** vehicle seats.
- **NEVER** install this Child Restraint in vehicle seats that face the rear or side of the vehicle.



- **NEVER** use this Child Restraint on boats, low speed vehicles (LSV), all-terrain vehicles (ATV), golf carts, or any other non-certified application.

**REAR-FACING Warnings** (when used with internal harness)

- **NEVER** turn a Child Restraint **FORWARD-FACING** with a child who weighs less than 26.5 lb (12 kg), is less than 34.3 inches (87 cm) tall, or is less than 1 year old. Crash forces may cause death or serious injury.
- **DO NOT USE** this Child Restraint if the top of your child's head is less than 1 inch (2.5 cm) from the top of the Headrest or Shell, whichever is higher, when used **REAR-FACING**.
- When using this restraint **REAR-FACING**, **DO NOT** loosen the vehicle seat belt to provide more leg room, as this may keep the Child Restraint from protecting the child.

## **! WARNING!** DEATH or SERIOUS INJURY can occur.

- Fold-down armrests could pose a hazard to a **REAR-FACING** child in certain types of collisions. Consult your vehicle Owner's Manual before installing any **REAR-FACING** car seat in front of a fold-down armrest.
  - **SOME CHILDREN WITH ADAPTIVE TRANSPORTATION NEEDS**, such as preemies or those who have tested positive for positional apnea, may be at increased risk of suffering breathing or other difficulties in a Child Restraint. Please consult a physician to determine what type of Child Restraint should be used.
  - **INFANTS MAY HAVE DIFFICULTY BREATHING WHEN IN AN UPRIGHT SEATED POSITION.** Make sure they recline enough for their head to lie back comfortably and safely. Failure to properly recline the Child Restraint could increase the child's risk of death or serious injury.
- FORWARD-FACING Warnings** (when used with internal harness)
- **DO NOT USE** this Child Restraint **FORWARD-FACING** if your child is less than 1 year old.
  - **DO NOT USE** this Child Restraint with internal harness if:
    - the child weighs more than 65 lb (29.5 kg) or is more than 49.2 inches (125 cm) tall.
    - the harness straps cannot be adjusted **AT** or **JUST ABOVE** the child's shoulders.
    - the tops of the child's ears are above the top of the Headrest.
- If any of these conditions exist, select BOOSTER MODE.**

## **! WARNING!** DEATH or SERIOUS INJURY can occur.

### **BOOSTER Warnings**

- **DO NOT** use **BOOSTER MODE** if your child is less than 4 years old.
- **DO NOT** use **REAR-FACING** in **BOOSTER MODE**.
- **DO NOT** use this Booster seat if the tops of the child's ears are above the back of the Booster seat Headrest.
- **NEVER** use a Lap Belt only.
- **Warning! Use only the vehicle's lap and shoulder belt system when restraining the child in this booster seat.**
- The Shoulder Belt **MUST** be threaded through the Shoulder Belt Path.
- The Shoulder Belt **MUST NOT** cross the child's neck or fall off the child's shoulder. If you cannot adjust the Shoulder Belt to properly lie midway

between the child's shoulder and neck **AND** at or just above the shoulder, try another seating location or do not use the Booster seat.

### **Child Fit Warnings**

- **ALWAYS CHECK** Harness Buckle to make sure it is securely latched.
- **ALWAYS** keep your child properly secured in the harness. A snug strap should not allow any slack. It lies in a relatively straight line without sagging. It does not press on the child's flesh or push the child's body into an unnatural position.
- **SNUGLY ADJUST** the belts provided with this Child Restraint around your child.
- **NEVER** use bulky clothing or blankets that will interfere with proper positioning or tightening the harness.

## **! WARNING!** DEATH or SERIOUS INJURY can occur.

### Additional Warnings

- **REGISTER** your Child Restraint with the manufacturer. This is the best way to reach you in the event of a recall.
- **NEVER USE** this Child Restraint when it is older than ten (10) years. The date of manufacture can be found on a label affixed to the bottom of the Child Restraint.
- **WHEN NOT IN USE**, securely store the Lower Anchor Connectors. Loose Connectors could seriously injure vehicle occupants in the event of a crash.
- **NEVER** use this Child Restraint if any of the Harness or Lower Anchor straps are cut, frayed, or damaged in any way.
- **NEVER** leave child unattended.
- Children have **STRANGLED** in loose or partially buckled harness straps. **FULLY RESTRAIN** the child.
- **DO NOT** allow children to play with this Child Restraint.
- **DO NOT** allow children to play with vehicle seat belts. A child within reach of a seat belt may become entangled if he or she pulls the seat belt all the way out and wraps the belt around his or her head, neck, or waist.
- **NEVER USE** accessories or parts with this Child Restraint other than those approved by CYBEX. Use of accessories or parts from other manufacturers could alter the performance of the Child Restraint.

## **! WARNING!** DEATH or SERIOUS INJURY can occur.

- **DO NOT** leave loose objects (e.g., groceries, books, bags) in a vehicle. In the event of a sudden stop, loose objects will keep moving, potentially causing serious injuries.
- **NEVER** tend to your child's needs while driving. **ALWAYS** safely stop your vehicle in order to tend to your child.
- **NEVER** take your child out of the Child Restraint while the vehicle is moving. Unrestrained occupants are at a greatly increased risk of death or serious injury in a car crash.

### Seat Belt Warnings

- **ALWAYS** read your vehicle Owner's Manual to determine what vehicle belts and retractors are used in your vehicle.
- **DO NOT** use this Child Restraint with inflatable seat belts.
- **DO NOT** use in a seating position with door-mounted seat belts.

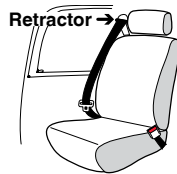

## **! WARNING!** DEATH or SERIOUS INJURY can occur.

- **DO NOT** use in a vehicle with seat belts that automatically move along the vehicle frame when the door is opened.



- **DO NOT** use with Lap/Shoulder Belts with two retractors. If the vehicle seat belts are not routed and fastened correctly, the Child Restraint may not protect the child in a crash.



- **DO NOT** use in a vehicle equipped with Lap Belts with ELRs (Emergency Locking Retractors that only lock during a sudden stop or crash). You must use a seating location with a Lap/Shoulder Belt or locking Lap Belt.



Check your vehicle Owner's Manual to see if your Lap Belts have ELRs.

- **DO NOT** use on vehicle seats when both portions of the lap-only belt are positioned forward of the seat crease.



- Check your vehicle Owner's Manual to determine how to lock your seat belt for Child Restraint installation. The seat belt must be locked to properly secure the Child Restraint.
- **DO NOT** allow the vehicle seat belt release button to touch the Child Restraint. Accidental contact may cause the seat belt to release. If necessary, turn the seat belt release button away from the Child Restraint or move the Child Restraint to a different location.

## **! WARNING!** DEATH or SERIOUS INJURY can occur.

The following vehicle belt systems are **SAFE** to use to install your Child Restraint in the vehicle. Review vehicle Owner's Manual for specific instructions on Child Restraint installation.

### **Lap/Shoulder Belt with Locking Latch Plate**

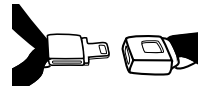

- The lap portion of this belt does not loosen once the belt is buckled.
- The vehicle belt is tightened by pulling up hard on Shoulder Belt and feeding the extra webbing into the retractor.

### **Lap/Shoulder Belt with Sliding Latch Plate with Locking Retractor**

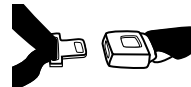

- The latch plate slides freely along the Lap/Shoulder Belt. Vehicle belts with sliding latch plates are typically locked at the Shoulder Belt retractor by buckling the belt and pulling all of the webbing out slowly to switch the retractor.
- After locking/switching the retractor, the vehicle belt is tightened by pulling up on Shoulder Belt and feeding the webbing into the retractor. Check vehicle Owner's Manual for specific instructions.

## **! WARNING!** DEATH or SERIOUS INJURY can occur.

### **Lap Belt with Locking Latch Plate**

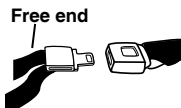

- Once buckled, the vehicle belt is tightened by pulling on the free end of the strap until the belt is tight.

### **Lap Belt with Automatic Locking Retractor (ALR)**



The automatic locking retractor does not allow the Lap Belt to get longer once it is buckled. The vehicle belt is tightened by feeding seat belt webbing into retractor.

### **LATCH Warnings**

**LATCH** (an acronym for **L**ower **A**nchors and **T**ethers for **C**hildren) refers to a pair of fixed Lower Anchors (or bars) and a Top Tether Anchor built into vehicles manufactured after

September 1, 2002. Your vehicle Owner's Manual may also refer to this system as **ISOFIX**, **UAS** (Universal Anchorage System), or **LUAS** (Lower Universal Anchorage System).

As shown here, the Lower Anchors are located in the crease, or bight, between the vehicle seat back and seat cushion, and, if not visible, will typically be indicated by the  symbol.

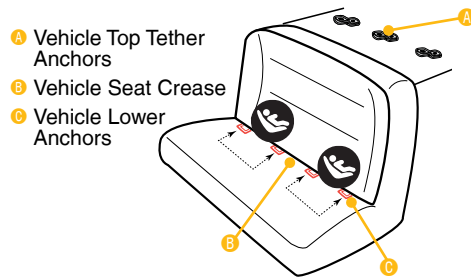

## **! WARNING!** DEATH or SERIOUS INJURY can occur.

Top Tether Anchors are located in various places behind the rear vehicle seat (pg. 43).

CYBEX allows this Child Restraint to be installed in Center Seating Positions using the two inner Lower Anchors from the outboard seating positions if the distance between them is between 11-20 inches (28-51 cm) AND if your vehicle manufacturer allows it. When using the inner Lower Anchors make sure there are no obstructions for the installation.

If distance is not correct and/or not allowed by vehicle manufacturer, use the vehicle belt for installation in the center position.

This Child Restraint can be safely installed using either **LATCH** or vehicle belts and meets the requirements of

FMVSS 213 with either installation method. Both methods are safe for your child when installed correctly and, with either method, CYBEX recommends using a Tether both **REAR-FACING** and **FORWARD-FACING**.

- The **LATCH** system is intended to be used **ONLY** as described in these instructions. Refer to your vehicle Owner's Manual for Lower Anchor positions in your vehicle.
- In addition to these instructions, read and follow your vehicle Owner's Manual regarding installation of the Child Restraint and **LATCH**. If there is a discrepancy, follow your vehicle Owner's Manual.
- ONLY** use Lower Anchor Connectors for securing Child Restraint to Vehicle Lower Anchors.

## **⚠ WARNING!** DEATH or SERIOUS INJURY can occur.

- **DO NOT** use Lower Anchor Connectors to attach this Child Restraint with a child weighing more than 30 lb (13.6 kg) **REAR-FACING** or 35 lb (15.9 kg) **FORWARD-FACING**. If these conditions cannot be met, **USE VEHICLE BELT INSTALLATION**.
- **ALWAYS** be sure that the Lower Anchor Connectors are attached to the Vehicle Lower Anchors by pulling hard on the connectors. If they are not attached, the Lower Anchor Connector assembly will not secure your Child Restraint. **DEATH or SERIOUS INJURY can occur.**
- **NEVER** attach two Lower Anchor Connectors to one Vehicle Lower Anchor.
- **TO AVOID STRANGULATION**, store excess Lower Anchor Connector Straps under the Base.

## Overview of the Callisto G 360 Front View

1. Canopy (closed)
2. Headrest
3. Infant Insert Head Pad
4. Seat Cover
5. Shoulder Pad (2)
6. SensorSafe Chest Clip
7. Harness Strap (2)
8. Harness Buckle
9. Buckle Pad
10. Harness Adjustment Button
11. Harness Adjustment Strap
12. Recline Adjustment Handle
13. Canopy Release Button (2)
14. Magnetic Buckle Tongue Holder (2)
15. Rotation Handle (2)
16. Shoulder Belt Guide (2)
17. Infant Insert Seat Pad
18. Lap Belt Path (2)
19. Cup Holder (2)
20. Recline Indicator Arrow (see closeup on pg. 29)

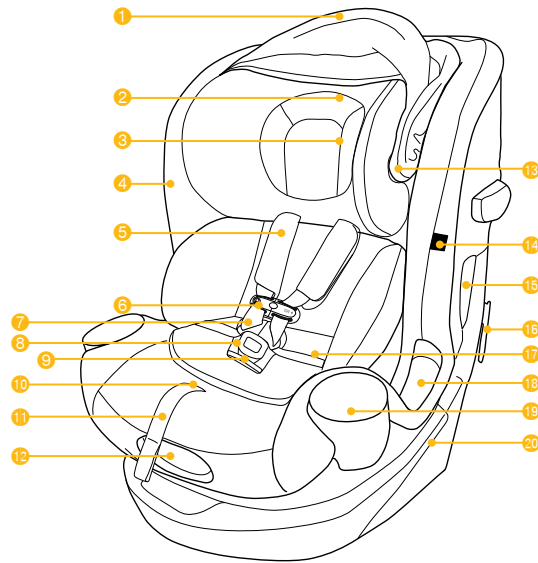

## Overview of the Callisto G 360

### Rear View

- 21. Headrest Height Adjustment Handle
- 22. Shoulder Belt Path (2)
- 23. Owner's Manual (stored)
- 24. SafeLock Belt Tensioner (open, below)
- 25. Tether Strap
- 26. Tether Adjuster
- 27. Tether Hook\*
- 28. Lower Anchor Connector (2)\*
- 29. Lower Anchor Adjuster and Lanyard\*

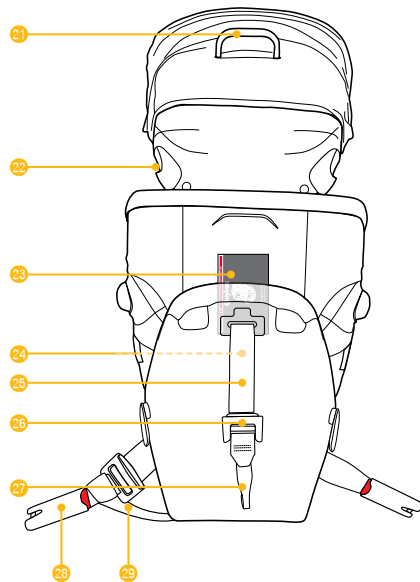
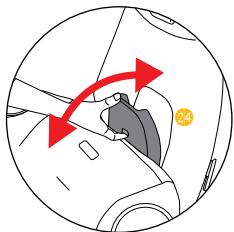

(\*shown stored on pg. 29)

## Overview of the Callisto G 360

### Additional Views

#### Recline Indicator

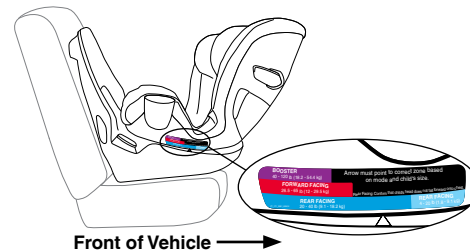

#### Underside of Base

- 1. Buckle Strap (stored under Lower Anchor Connector in Booster Mode)
- 2. Lower Anchor Connector (stored)
- 3. Tether Hook (stored)
- 4. Lower Anchor Connector, Anchor Adjuster, and Lanyard (stored)

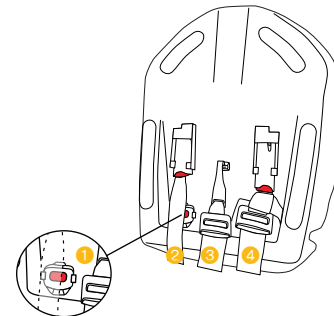

## Product Features

### Adjustable Buckle Strap

As your child grows, the Adjustable Buckle Strap will need to be repositioned. The Buckle Strap should **ALWAYS** be as close to but **NEVER** underneath the child's bottom.

To move the Adjustable Buckle Strap:

1. Remove Buckle Pad from Buckle Strap through Seat Pad.
2. Unfasten two snaps on Seat Pad and pull Seat Pad forward.
3. Slide the Buckle Strap out through the bottom of the Seat Pad opening.
4. Grasp the Buckle Strap and twist it to align lengthwise.
5. Move Buckle Strap to slot **closest to but NEVER underneath the child's bottom** and twist Buckle Strap back into position.
6. Feed Buckle Strap through bottom of Seat Pad and reattach Buckle Pad, then replace the Seat Pad and fasten the two snaps.

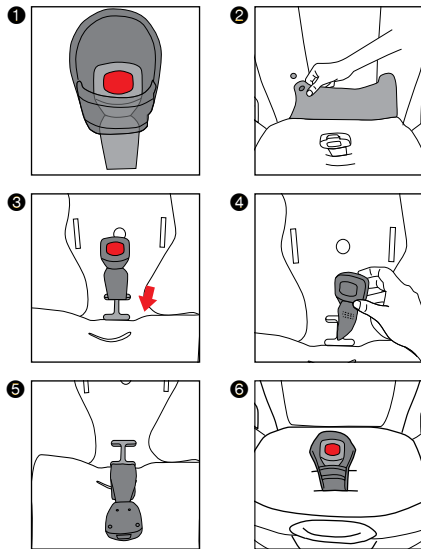

## Product Features

### Cup Holders

## ⚠ WARNING! DEATH or SERIOUS INJURY can occur.

- **ONLY** use the Cup Holders that come with your Callisto G 360 or have been specifically designed for it by CYBEX.
- **DO NOT** use the Cup Holders to hold hot liquids (e.g., coffee), even in enclosed or lidded containers. Placing hot liquids in the Cup Holders could result in spills and burn injuries to you or your child.
- **NEVER** place sharp or pointed objects in the Cup Holders. In a crash these objects could hit you or your child and cause serious injuries.
- **ONLY** use containers that fit securely all the way to the bottom of the Cup Holders. They should not stop halfway down when placing containers in the Cup Holders.
- **ONLY** use containers with a capacity of 12 ounces (355 ml) or less.
- **NEVER** use any containers which are made of brittle material (e.g., glass). This could lead to injuries in the event of a crash.
- **NEVER** leave open containers in the Cup Holders during the journey. There is a risk of spilling (e.g., when braking), which may cause damage to seat upholstery or the electrical components of the vehicle.
- **ALWAYS** remove containers before reclining or rotating the car seat. There is a risk of spilling, which may cause damage to seat upholstery or the electrical components of the vehicle.



## Product Features

### Cup Holders

This Child Restraint is equipped with two removable Cup Holders for easy installation. These Cup Holders are top-rack dishwasher safe (pg. 75).

#### To Install:

1. Identify the right and left Cup Holders.

Cup Holders are labeled "R" and "L" with an arrow indicating the direction to rotate for proper installation.

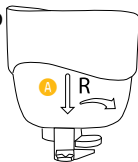

2. Align the straight arrows on the Cup Holder **A** and Child Restraint **B**, then place the Cup Holder into position.
3. Push down on the Cup Holder and rotate toward the seat back **C** until it locks in place. Pull up to ensure it is secure.

#### To Remove:

1. Push the button on the underside of the Cup Holder and rotate toward the front of the seat.
2. Pull the Cup Holder out.

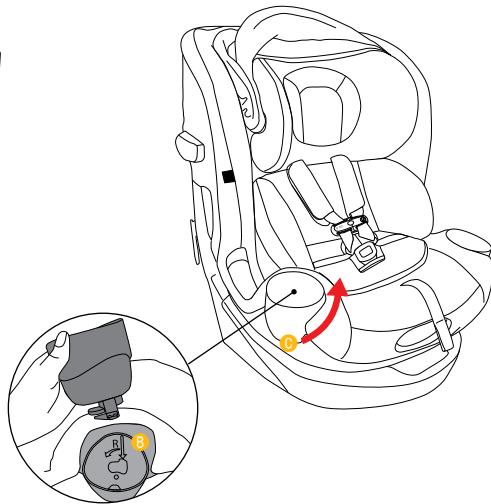

## Product Features

### Harness Adjustment

Loosen Harness by firmly pressing down the Harness Adjustment Button **A** while pulling forward on both Harness Straps **B** at shoulder level.

Tighten Harness by pulling the Harness Adjuster Strap **C**.

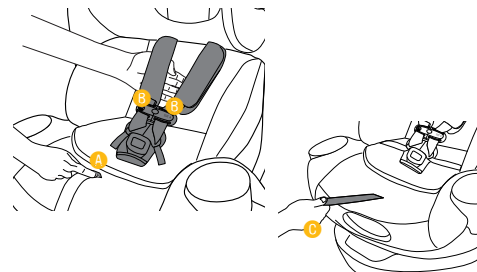

### Harness Buckles

To release Buckle Tongues, firmly press the red button on the Harness Buckle and pull the tongues out.

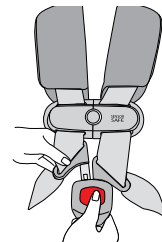

To fasten, insert each Buckle Tongue into the Buckle, listening for an audible **CLICK**. Pull on each to verify a secure connection.

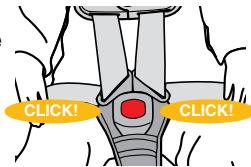

Check that the Buckle functions properly and is kept free of dirt and debris. For Care and Cleaning, see pg. 75.

## Product Features

### Infant Insert

The Infant Insert consists of two separate pieces, a Head Pad and a Seat Pad with a removable Foam Wedge that can be used with babies or smaller infants to improve Harness Fit and Recline Angle.

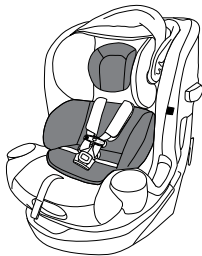

**Seat Pad** (for use up to 11 lb (5 kg) with Foam Wedge, or 20 lb (9kg) without)

To remove the Seat Pad, unsnap the snaps on the sides of the Seat Pad and remove the Harness Straps.

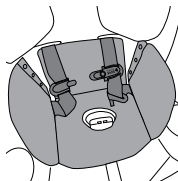

When reinstalling the Seat Pad, be sure to feed the Harness Straps over the back and through the cutouts at the rear corners of the Seat Pad before securing the snaps.

**Seat Pad Foam Wedge** (designed to improve fit for babies or smaller infants)

Remove the Foam Wedge **A** from the Seat Pad **B** by unsnapping the snaps at the rear of the Seat Pad and pulling the Foam Wedge out as shown.

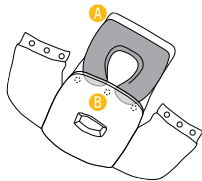

**Head Pad** (for use up to 20 lb (9 kg) for improved comfort or fit)

- To remove the Head Pad, pull away from Headrest so the two tabs on the Head Pad will slide out of the slots on the Headrest cover.

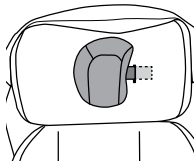

## Product Features

### Lower Anchors

**⚠ WARNING! DEATH or SERIOUS INJURY can occur.**

- WHEN NOT IN USE**, securely store the Lower Anchor Connectors. Loose Connectors could seriously injure vehicle occupants in the event of a crash.
- TO AVOID STRANGULATION**, store excess Lower Anchor Connector Straps under the Base.

**Removing the Lower Anchors from storage:**

- From the underside of the Base, press the Button on each Lower Anchor Connector, pushing connector forward **A** while pulling on connector strap **B** to release from Base.
- Lengthen the strap between the Connectors by pushing and holding the button on the Adjuster **C** while pulling on the strap.
- Make sure the Lower Anchor Adjuster **D** is on the appropriate side of the Child Restraint as shown.

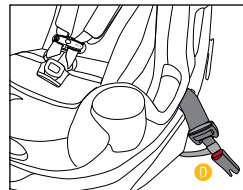
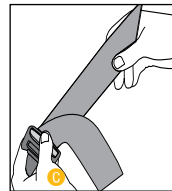
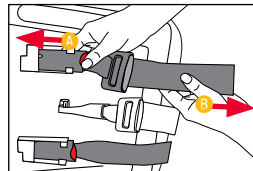

**DO NOT REMOVE THE ADJUSTER LANYARD.**

## Product Features

### Lower Anchors

#### Storing the Lower Anchors:

1. Replace the Lower Anchor Connectors into their storage slots on the underside of the Base. An audible **CLICK** will be heard.
2. Place the Lower Anchor Adjuster and Adjuster Lanyard in the storage compartment below the right Lower Anchor Connector.
3. Route excess Lower Anchor Connector Strap under Base to store.

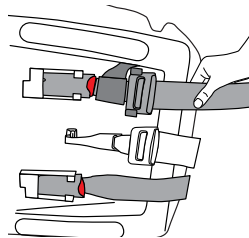
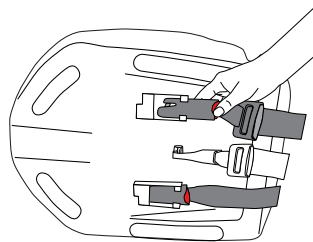

## Product Features

### No-Rethread Harness and Headrest Adjustment

This Child Restraint has a Headrest that automatically adjusts Harness height without needing to undo and rethread the Harness. Using the No-Rethread Harness, the Headrest may be adjusted up and down through 12 positions to fit your child.

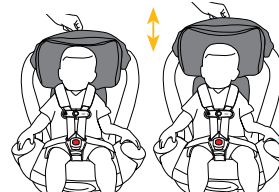

#### To Adjust the Headrest:

1. Loosen Harness by firmly pressing down on Harness Adjustment Button while pulling forward on both Harness Straps at shoulder level.
2. Unbuckle Harness and Chest Clip, then drape Harness over sides of Child Restraint.
3. Place child in restraint, making sure their back and bottom are flush with the restraint and the Buckle Strap is snug

against the child, but NOT under the child's bottom.

4. Adjust for your child by pulling up on the Headrest Height Adjustment Handle **A** while sliding the Headrest up.

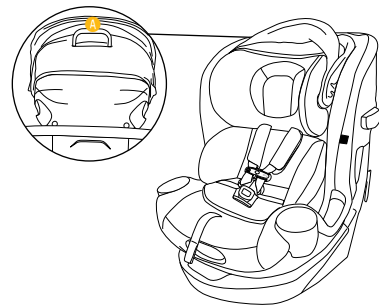

For **REAR-FACING** use, adjust Headrest so the harness straps are **AT or JUST BELOW** the child's shoulders.

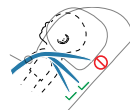

## Product Features

### No-Rethread Harness and Headrest Adjustment

For **FORWARD-FACING** use, adjust Headrest so the harness straps are **AT or JUST ABOVE** the child's shoulders.



See "Helpful Tips" on pg. 77.

Buckle and tighten Harness, then place chest clip at armpit level.

Regularly check for proper Harness height as your child grows.

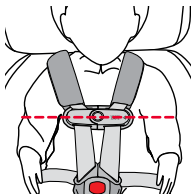

### Removable Canopy

The Removable Canopy can be used both **REAR-FACING** and **FORWARD-FACING**. To use the Canopy, pull forward to extend or push back to close. The Canopy can be stored closed or removed as described below.

- **To Remove Canopy:** Squeeze release buttons on sides of Canopy and pull tabs from slots on Headrest.
- **To Reattach Canopy:** Insert tabs into slots on sides of Headrest and push in until you hear a **CLICK**.

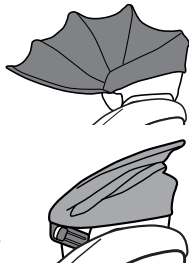

**DO NOT** use Canopy in **BOOSTER MODE**.

**DO NOT** lower the canopy below the top of the child's head when using the child restraint **FORWARD-FACING**.



## Product Features

### Seat Rotation and Recline

### **⚠ WARNING! DEATH or SERIOUS INJURY can occur.**

- When properly installed, the Callisto G 360 rotates in its base to safely load and unload your child. The loading/unloading position is used **ONLY** for placing or removing the child from the seat.
- **ALWAYS** return the seat to a locked **REAR-FACING** or **FORWARD-FACING** position. The seat **MUST** be locked and in the proper recline zone for your child before driving.
- Failure to properly recline the Child Restraint could increase the child's risk of death or serious injury. Infants may have difficulty breathing when in an upright seated position. Make sure they recline enough for their head to lie back comfortably and safely.

1. To rotate the Child Restraint, pull the rotation handle on either side of the Child Restraint and rotate the seat to the loading/unloading position.
2. Place the child in the seat (see pgs. 61-67).

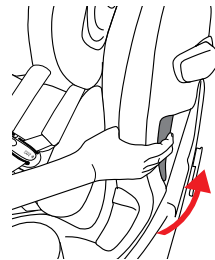

## Product Features

### Seat Rotation and Recline

3. When the child is securely harnessed, rotate the seat **REAR-FACING** or **FORWARD-FACING** (see pgs. 10-11) and ensure the seat is locked.

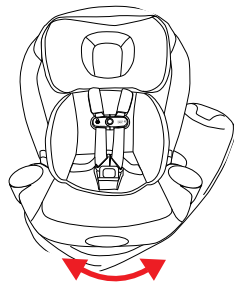

4. Squeeze the Recline Adjustment Handle **A** to recline the seat to the appropriate position based on your child's weight.

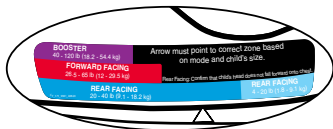

The Recline Indicator Arrow (pgs. 27, 29) **MUST** be within the correct recline zone for proper use.

See "Helpful Tips" on pg. 77.

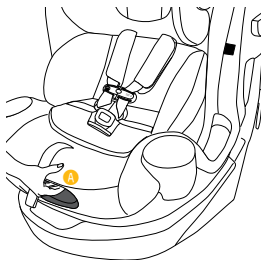

## Product Features

### SensorSafe Chest Clip

The Callisto G 360 is equipped with a SensorSafe Chest Clip that works with the CYBEX Mobile App, which is available for download at the Apple App Store® or on Google Play™.\*

The CYBEX Mobile App provides the following to your smartphone:

- A reminder that your child is still in the vehicle
- An alert if the chest clip is opened while driving
- The current temperature of your vehicle interior
- Owner's Manuals for CYBEX Child Restraints
- Contact information for CYBEX Consumer Services

See the CYBEX SensorSafe Mobile App User Guide included with this product or contact CYBEX Consumer Services at 1-877-242-5676.



\* Trademarks are the property of their respective owners.

To separate the SensorSafe Chest Clip, push button and pull apart.

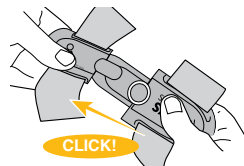

To fasten, slide the two pieces together until an audible **CLICK** is heard.

Always position the center of the SensorSafe Chest Clip even with the child's armpits.

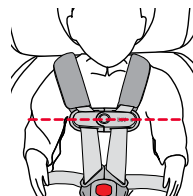

The optional Shoulder Pads, if used, are installed above the SensorSafe Chest Clip for comfort.

**ALWAYS** make sure the Shoulder Pads **DO NOT** bunch up when tightening the harness.

**To Remove:** Unsnap and remove Shoulder Pads as shown at right.

**To Replace:** Wrap Shoulder Pads around Harness Straps and fasten snaps. Make sure Shoulder Pads are oriented as shown.

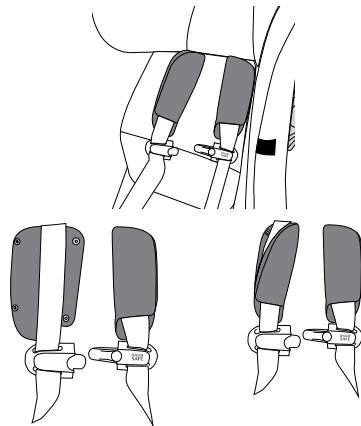

**! WARNING! DEATH or SERIOUS INJURY can occur.**

To avoid **STRANGULATION** or **ENTANGLEMENT**, you **MUST** store the Tether on the underside of the Base when not in use. This will also keep an unused Tether or Tether Hook from hitting someone during a crash.

**CYBEX recommends using a Tether both REAR-FACING and FORWARD-FACING.**

A Tether reduces movement of a Child Restraint in a crash and helps to achieve a tight installation.

The Tether Strap and Lower Anchor Connectors may only be used to secure the Booster seat to the vehicle seat **if the Booster seat's position in the vehicle and/or the resulting fit of the vehicle seat belt over the child are not affected.**

Tether anchor locations vary from vehicle to vehicle and some typical locations are shown at right.

Look for the Tether Anchor icon or refer to your vehicle Owner's Manual for exact locations, anchor identification, and requirements.

Some older vehicles may not come equipped with Tether Anchor hardware. Check with your vehicle manufacturer.

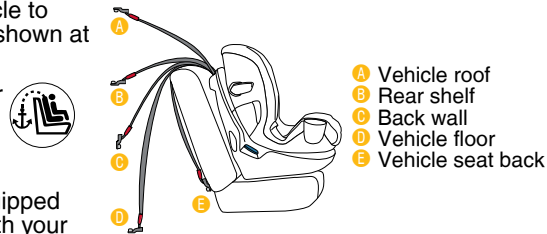

## Installing the Callisto G 360 Installation with Lap/Shoulder Belt (Preferred Method)

CYBEX recommends using a Tether both **REAR-FACING** and **FORWARD-FACING** when installing the seat using Lap/Shoulder Belts. See pg. 43 for more information.

1. Ensure that Lower Anchor Connectors and Adjuster are properly stored on the underside of the Base (see pgs. 35-36).
2. Place Child Restraint on rear vehicle seat in an approved seating position.

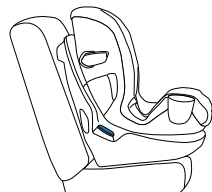

Front of Vehicle →

3. Locate the vehicle Tether Anchor and attach the Tether Hook (pg. 28). **DO NOT TIGHTEN.**

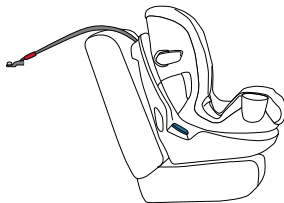

## Installing the Callisto G 360 Installation with Lap/Shoulder Belt (Preferred Method)

4. Rotate Child Restraint **REAR-FACING** and adjust Seat Recline (pgs. 39-40) to the most upright position.

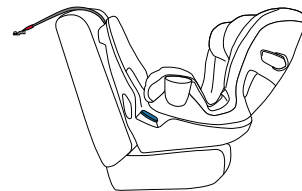

Front of Vehicle →

5. Open the SafeLock Belt Tensioner.

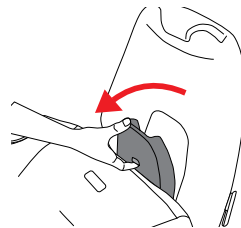

## Installing the Callisto G 360

### Installation with Lap/Shoulder Belt (Preferred Method)

6. **ROUTE THE LAP PORTION OF THE VEHICLE BELT** under the SafeLock Belt Tensioner and across the blue Belt Path.
7. **BUCKLE THE VEHICLE BELT.** Make sure the belt lies flat and is not twisted.
8. **REMOVE SLACK FROM LAP PORTION OF VEHICLE BELT** by pulling Shoulder Portion of Belt.  
**DO NOT OVERTIGHTEN.** SafeLock Belt Tensioner will tighten belt fully.
9. **ROUTE THE SHOULDER PORTION OF THE VEHICLE BELT** back under the SafeLock Belt Tensioner and across the blue Belt Path, ensuring it lays flat on top of the Lap Portion.

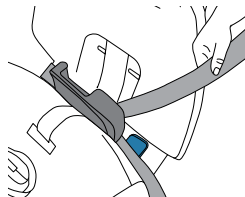
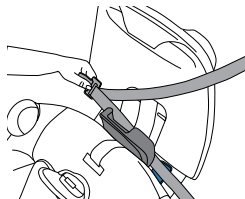

**NEVER** place a vehicle belt over the Belt Tensioner, even in a vehicle with longer buckle stalks.

## Installing the Callisto G 360

### Installation with Lap/Shoulder Belt (Preferred Method)

10. Close the SafeLock Belt Tensioner.  
If Belt Tensioner does not lock, slightly loosen Lap/Shoulder Belt.  
Some vehicle belts have features that may interfere with routing the belt or closing the Belt Tensioner.  
If so, you may need to try a different vehicle seat location and/or installation method, or contact CYBEX Consumer Services for more information.
11. **Route Shoulder Portion of Vehicle Belt** behind the Shoulder Belt Guide on the side of the Base.  
Shoulder Belt Guide may be rotated upward for easier access but **MUST** be returned to its original position once the vehicle belt is routed.

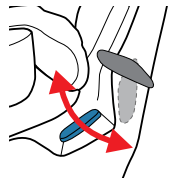
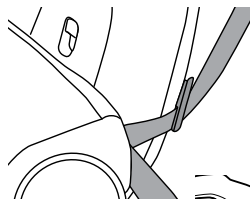
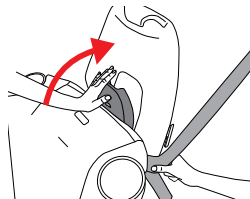



## Installing the Callisto G 360

### Installation with Lap/Shoulder Belt (Preferred Method)

12. Grab Base as shown and pull side to side and front to back to make sure Base is installed tightly. Base should not move more than 1 inch (2.5 cm).

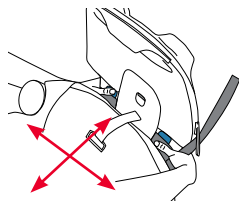

**If Base moves too much**, open SafeLock Belt Tensioner, remove additional slack from the vehicle belt, and try again.

See "Helpful Tips" on pg. 77.

13. Lock the vehicle belt retractor.\*

**NEVER** install this Child Restraint using a non-locking vehicle Lap/Shoulder Belt.

Refer to your vehicle Owner's Manual for information.

14. Pull Tether Adjuster Strap to tighten fully, then tuck free end of Tether Strap between Base and vehicle seat.

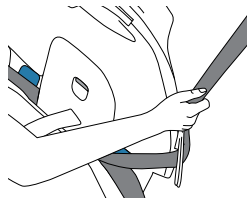

\* **In most vehicles**, you can switch the belt retractor into locking mode by pulling out the shoulder portion of the belt all the way and letting it rewind into the retractor. **Pull on Shoulder Belt to ensure that it is locked.**

## Installing the Callisto G 360

### Installation with Lower Anchors

CYBEX recommends using a Tether both **REAR-FACING** and **FORWARD-FACING** when installing the seat using Lower Anchors. See pg. 43 for more information.

**IMPORTANT: DO NOT** use Lower Anchors in **REAR-FACING** mode if child weighs more than 30 lb (13.6 kg) or in **FORWARD-FACING** mode if child weighs more than 35 lb (15.9 kg).

1. Remove Lower Anchor Connectors and Adjuster from storage on the underside of the Base (see pgs. 35-36).
2. Place Child Restraint on rear vehicle seat in an approved seating position.

Make sure the Lower Anchor Adjuster is on the appropriate side of the Child Restraint (see pgs. 35-36). **DO NOT REMOVE THE ADJUSTER LANYARD.**

3. Locate the vehicle Tether Anchor and attach the Tether Hook (pg. 28). **DO NOT TIGHTEN.**

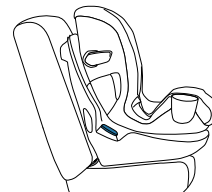

Front of Vehicle →

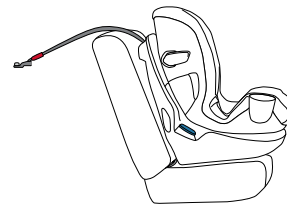

## Installing the Callisto G 360

### Installation with Lower Anchors

4. Rotate Child Restraint **REAR-FACING** and adjust Seat Recline (pgs. 39-40) to the most upright position.

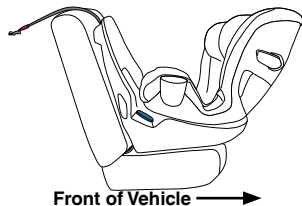

5. Open the SafeLock Belt Tensioner.

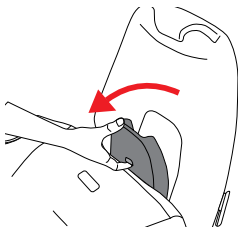

## Installing the Callisto G 360

### Installation with Lower Anchors

6. **ROUTE THE LOWER ANCHOR CONNECTOR STRAP** under the SafeLock Belt Tensioner and across the blue Belt Path.

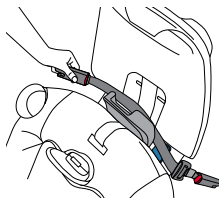

7. **ATTACH LOWER ANCHOR CONNECTORS TO VEHICLE LOWER ANCHORS.** Pull to confirm that each connector is attached to the anchor.
8. Tighten Lower Anchor Connector Strap by pulling on loop until snug.  
**DO NOT OVERTIGHTEN.** SafeLock Belt Tensioner will tighten Lower Anchor Strap fully.

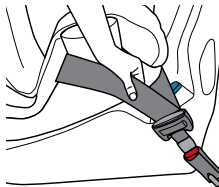

## Installing the Callisto G 360

### Installation with Lower Anchors

- Route excess Lower Anchor Strap across the blue Belt Path and close the SafeLock Belt Tensioner.

If Belt Tensioner does not lock, slightly loosen Lower Anchor Strap.

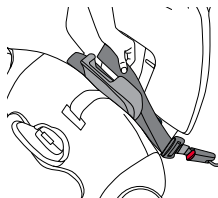

- Grab Base as shown and pull side to side and front to back to make sure Base is installed tightly. Base should not move more than 1 inch (2.5 cm).

**If Base moves too much**, open SafeLock Belt Tensioner, remove additional slack from the Lower Anchor Strap, and try again.

See "Helpful Tips" on pg. 77.

- Pull Tether Adjuster Strap to tighten fully, then tuck free end of Tether Strap between Base and vehicle seat.

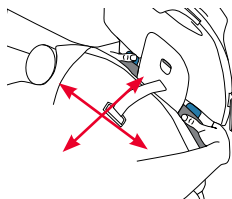

## Installing the Callisto G 360

### Installation with Lap Belt Only

**CYBEX recommends using a Tether both REAR-FACING and FORWARD-FACING when installing the seat using Lap Belt Only.** See pg. 43 for more information.

- Ensure that Lower Anchor Connectors and Adjuster are properly stored on the underside of the Base (see pgs. 35-36).

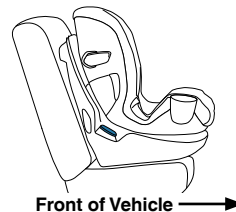

- Place Child Restraint on rear vehicle seat in an approved seating position.

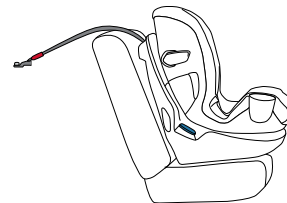

## Installing the Callisto G 360

### Installation with Lap Belt Only

3. Locate the vehicle Tether Anchor and attach the Tether Hook (pg. 28). **DO NOT TIGHTEN.**

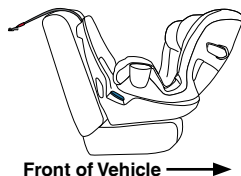

4. Rotate Child Restraint **REAR-FACING** and adjust Seat Recline (pgs. 39-40) to the most upright position.
5. Open the SafeLock Belt Tensioner.

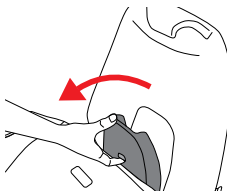

## Installing the Callisto G 360

### Installation with Lap Belt Only

6. **ROUTE THE LAP BELT** under the SafeLock Belt Tensioner and across the blue Belt Path.
7. **BUCKLE THE VEHICLE BELT.** Make sure the belt lies flat and is not twisted.

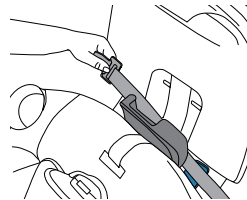

8. **REMOVE SLACK FROM LAP BELT** by pulling up on loose end of belt. **DO NOT OVERTIGHTEN.** SafeLock Belt Tensioner will tighten belt fully.

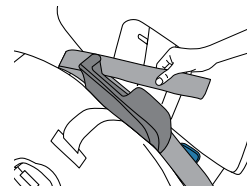

**NEVER** place a vehicle belt over the Belt Tensioner, even in a vehicle with longer buckle stalks.

## Installing the Callisto G 360

### Installation with Lap Belt Only

9. Route excess vehicle belt across the blue Belt Path and close the SafeLock Belt Tensioner.

If Belt Tensioner does not lock, slightly loosen the Lap Belt.

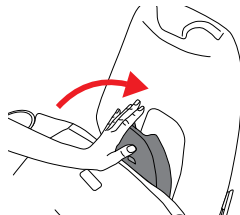

10. Grab Base as shown and pull side to side and front to back to make sure Base is installed tightly. Base should not move more than 1 inch (2.5 cm).

**If Base moves too much**, open SafeLock Belt Tensioner, remove additional slack from the vehicle belt, and try again.

See "Helpful Tips" on pg. 77.

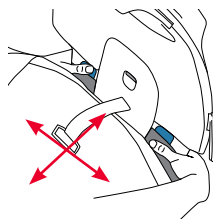

11. Pull Tether Adjuster Strap to tighten fully, then tuck free end of Tether Strap between Base and vehicle seat.

## Removing the Child Restraint from the Vehicle

### To Remove the Child Restraint:

1. Rotate Child Restraint **REAR-FACING** and adjust Seat Recline (pgs. 39-40) to the most upright position.
2. Unfasten vehicle belt **A** or Lower Anchor Connectors **B**.
3. Open the SafeLock Belt Tensioner **C** and remove the vehicle belt or Lower Anchor Connectors.
4. Remove the Tether.
  - a. Press Adjuster Release Button.
  - b. Lengthen Tether Strap and unhook from Tether Anchor.
  - c. Place Tether in storage compartment on underside of Base **D** as shown on pgs. 35-36.  
If used, place Lower Anchors in storage compartment at this time.
5. Close the SafeLock Belt Tensioner.
6. Rotate Child Restraint **FORWARD-FACING** and remove from vehicle.

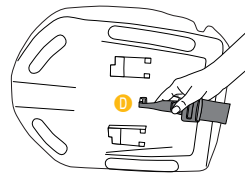
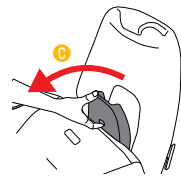
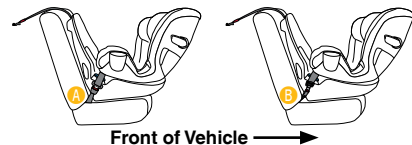

### CONVERTING TO BOOSTER MODE

1. With the seat in **FORWARD-FACING** mode, loosen the harness straps by pushing the Harness Release Button on the front of the seat and pulling the harness straps at the same time.
2. Raise the Headrest to the highest position (see pgs. 37-38).
3. Remove the Canopy (pg. 38).
4. Unfasten SensorSafe Chest Clip and Harness Buckle Tongues.
5. Remove Buckle Pad from Buckle Strap and save for later use.
6. Unfasten two snaps on Seat Pad and pull Seat Pad forward.
7. Remove Buckle Strap.
  - a. Slide Buckle Strap out through bottom of Seat Pad opening.
  - b. Grasp Buckle Strap, twist it to align lengthwise, then slide it toward the front of the seat while pulling out.
  - c. Store Harness Buckle and Strap on underside of the Base (see pgs. 35-36).

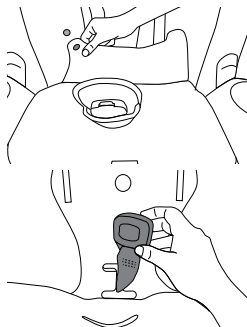
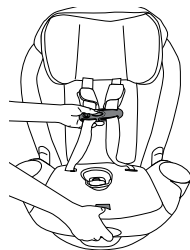

8. Store Harness Straps, Shoulder Pads, and Harness Buckle Tongues inside the side wings, underneath the Seat Cover.

The Harness Adjuster Strap may be folded over and tucked into the Adjuster Strap Opening while in **BOOSTER MODE**.

9. Reattach Seat Pad and adjust Booster Headrest to fit the child as shown on pg. 60. The Callisto G 360 is now in **BOOSTER MODE**.

Reverse these steps to convert back to Harness Mode.

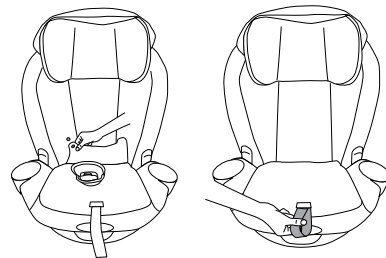
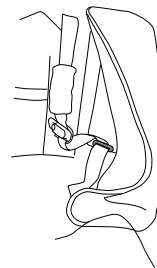

### USING BOOSTER MODE

1. Place Booster seat on a **FORWARD-FACING** vehicle seat with a Lap/Shoulder Belt.

The Base should sit as flat as possible on the vehicle seat, touching the vehicle seat back and bottom.

The Tether Strap and Lower Anchor Connectors may only be used to secure the Booster seat to the vehicle seat **if the Booster seat's position in the vehicle and/or the resulting fit of the vehicle seat belt over the child are not affected.**

2. Place child in Booster seat, fasten vehicle belt, and listen for an audible **CLICK**.

Always pass Lap portion of vehicle belt through Lap Belt Path **A** and Shoulder portion through Shoulder Belt Path **B** as shown. **NEVER** use a Lap Belt only **C**.

3. Adjust Headrest height so vehicle Shoulder Belt lies between child's neck and shoulder. Vehicle belts must lie flat and not be twisted.

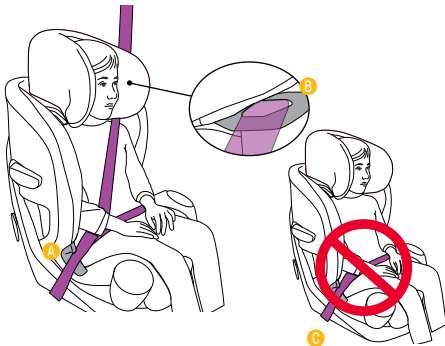

### **⚠ WARNING! DEATH or SERIOUS INJURY can occur.**

- **NEVER** secure child in Child Restraint with child dressed in bulky or heavy clothing. Heavy clothing can prevent Harness from being properly tightened around the child.
- **NEVER** secure child in Child Restraint with child wrapped in a blanket. To keep child warm, place a blanket over the child **AFTER** you have properly secured and tightened Harness around the child.

1. Loosen harness by firmly pressing down on the Harness Adjustment Button while pulling forward on both Harness Straps at shoulder level.

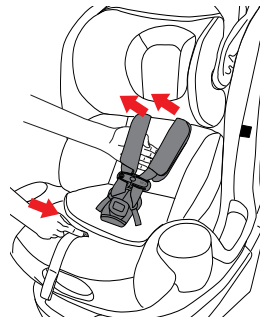

## Securing the Child with Harness

### 2. Open the Harness:

- Press red button on Harness Buckle to release Harness Buckle Tongues.
- Open SensorSafe Chest Clip and spread Harness Straps apart.

To preserve battery life, always store the SensorSafe Chest Clip in the unclipped position.

- Secure Harness Buckle Tongues to seat using Magnetic Buckle Tongue Holders.

- ### 3. Place child in Restraint with their back and bottom flat against the Restraint. Pull Harness Straps over child's shoulders and around child's waist. Straps must lie flat, free of twists, and in the center of the child's shoulders.

If Buckle Strap is under the child, it will need to be adjusted (pg. 30).

To ensure a better fit with smaller infants, the Infant Insert (pg. 34) may need to be used. **ONLY USE** the Infant

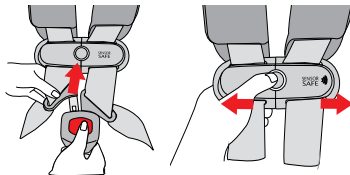

## Securing the Child with Harness

Insert that comes with your car seat or has been specifically designed for it by CYBEX. **NEVER** place any other padding under or behind the child.

- ### 4. Adjust the Headrest height (pgs. 37-38) so that the Harness Straps are positioned:

- AT or JUST BELOW** the child's shoulders when **REAR-FACING**.

Child's Head **MUST** be 1 inch (2.5 cm) or more below the top of the Headrest or shell, whichever is higher.

- AT or JUST ABOVE** the child's shoulders **FORWARD-FACING**

Top of Child's ears **MUST** be below the top of the Headrest.

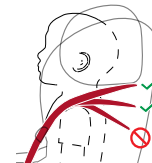
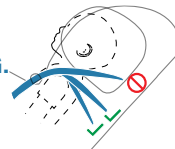

See "Helpful Tips" on pg. 77.

- ### 5. As you adjust the Headrest position, fold the excess Headrest Flap behind the Headrest Cover at the fold lines shown.

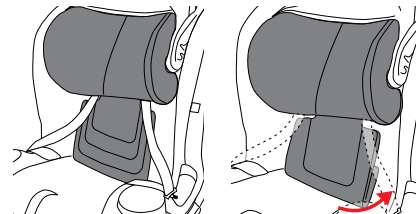

In the lowest headrest position, ensure that the bottom section is folded as shown.

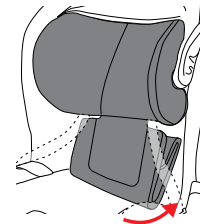



## Securing the Child with Harness

6. Fasten buckle by inserting one tongue at a time into the Harness Buckle listening for an audible **CLICK**. Pull up firmly on both Buckle Tongues to make sure they are securely latched.

- **CHECK** that the Buckle functions properly and is kept free of dirt and debris.
- Make sure Harness Straps are not twisted.

7. Fasten Chest Clip by snapping both sides together. Listen for a **CLICK**.

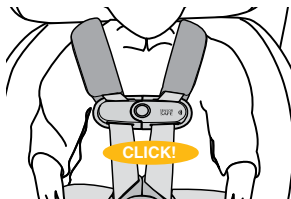
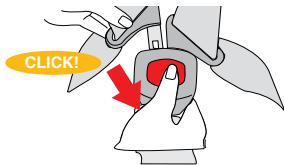

## Securing the Child with Harness

8. Push Chest Clip and Shoulder Pads down away from the child's neck and towards the Harness Buckle.

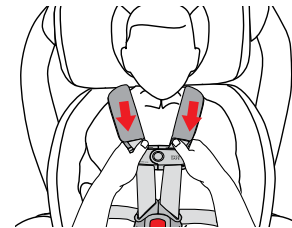

9. Pull up on both Harness Straps to remove all slack from the Straps around the child's hips.

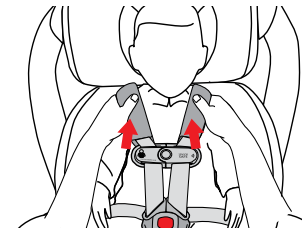

## Securing the Child with Harness

10. Slowly pull Harness Adjuster Strap to tighten Harness Straps while holding Chest Clip so it does not ride up into child's neck.

**If you can pinch the Strap** at the child's shoulders, the **Harness is too loose**. Pull Harness Adjuster Strap until Harness is snug on child.

A snug strap should not allow any slack. It lies in a relatively straight line without sagging. It does not press on the child's flesh or push the child's body into an unnatural position.

11. Position Chest Clip at armpit level as shown.
12. Recline the seat to the appropriate position based on your child's weight (see pgs. 10, 40).

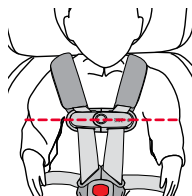
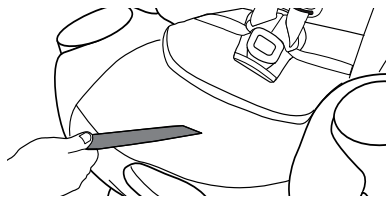

## Securing the Child with Harness

13. To loosen Harness, firmly press down the Harness Adjustment Button while pulling forward on both Harness Straps at shoulder level.

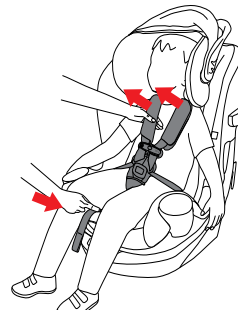

14. Open the SensorSafe Chest Clip.
15. Press red button on Harness Buckle and remove Harness Buckle Tongues.
16. Secure Harness Buckle Tongues to seat using Magnetic Buckle Tongue Holders.
17. Remove the child.

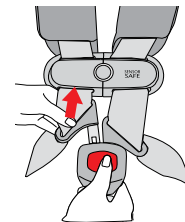

### **⚠ WARNING! DEATH or SERIOUS INJURY can occur.**

- The Child Restraint must **NEVER** be used without the Seat Cover.
- **DO NOT** damage, remove, or dispose of the foam lining the Headrest or sides of the Shell on this Child Restraint. Each foam piece was designed to absorb energy in a crash.

### REMOVING THE SEAT COVER

1. Use Headrest Height Adjustment Handle **A** (behind Canopy, pg. 28) to raise Headrest to its highest position (pgs. 37-38).
2. From rear of seat, pull back of Headrest Cover out of channel around seat shell **B** and unsnap cover from seat.
3. If using Canopy **C** (pg. 36) or Infant Insert **D** (pg. 34), remove them from Child Restraint.
4. Remove Shoulder Pads **E** (pg. 42).
5. Open SensorSafe Chest Clip **F** (pg. 41).
6. Unfasten Harness Straps **G** (pg. 33) from Harness Buckle **H** (pg. 33) and remove Buckle Pad **I** (pg. 30) if used.

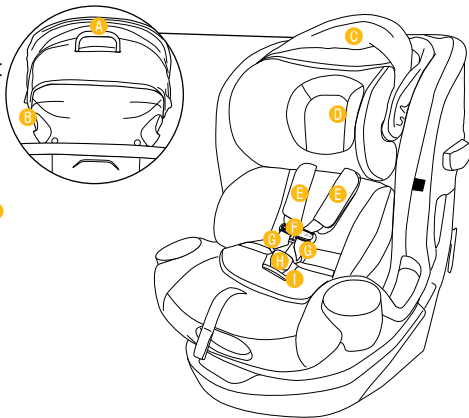

7. Remove the Headrest Cover from the Headrest.

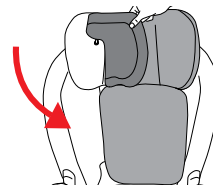

8. Remove the Seat Cover from the Child Restraint.
  - a. Unsnap the two snaps securing the Back Padding to the Seat Cover and pull forward.
  - b. Untuck Seat Cover from around the edges of the seat and pull the Seat Cover away from the Child Restraint.

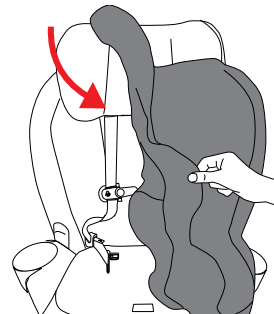

### INSTALLING THE SEAT COVER

1. Install the Seat Cover onto the Child Restraint.
  - a. From the top of the seat, tuck the Seat Cover around the edges of the Child Restraint.
  - b. Secure the two snaps on the Back Padding to the Seat Cover.
2. Install the Headrest Cover to the Headrest.

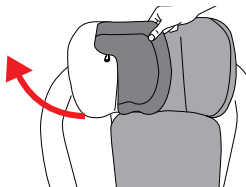
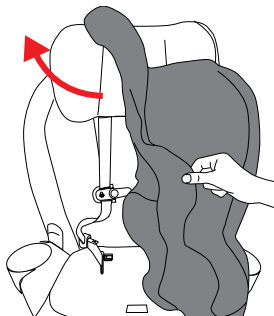

3. Install Buckle Pad **I** (pg. 30) if used, then fasten Harness Straps **G** (pg. 33) to Harness Buckle **H** (pg. 33).
4. Close SensorSafe Chest Clip **F** (pg. 41).
5. Install Shoulder Pads **E** (pg. 41).
6. If using Canopy **C** (pg. 36) or Infant Insert **D** (pg. 34), reinstall them to Child Restraint.
7. From rear of seat, tuck Headrest Cover into channel around seat shell **B** and snap cover onto seat.
8. Adjust for your child by pulling up on the Headrest Height Adjustment Handle **A** (pg. 28) while sliding the Headrest up (pgs. 37-38).

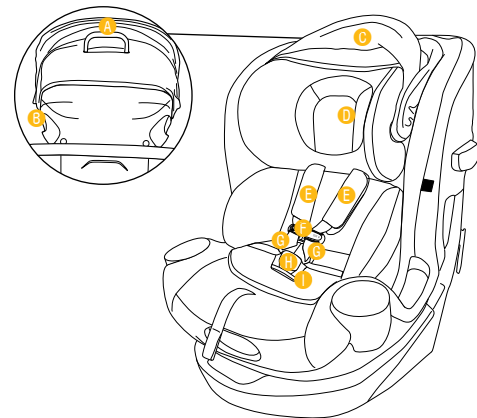

## Installing Callisto G 360 in an Aircraft

The Federal Aviation Administration (FAA) recommends that you secure your child for air travel in an appropriate Child Restraint based on your child's weight and size.

Turbulence can happen with little or no warning. When turbulence occurs, the safest place for your child is in a properly installed Child Restraint, not in an adult's lap or on the aircraft seat with its seat belt.

Keeping your child in a Child Restraint during the flight will help ensure your family arrives safely at your destination.

1. Make sure the aircraft seat is in the fully upright and locked position.
2. Ensure that Lower Anchor Connectors, Adjuster, and Tether are properly stored on the underside of the Base (pgs. 35-36).
3. Raise aircraft armrest and position Child Restraint **REAR-FACING** in aircraft window seat.

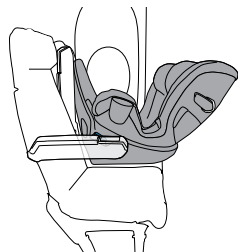

The FAA recommends that a child weighing:

- less than 20 lb (9 kg) use a **REAR-FACING** Child Restraint.
- from 20-40 lb (9-18.2 kg) use a **FORWARD-FACING** Child Restraint.
- more than 40 lb (18.2 kg) use an aircraft seat belt.

Please note that these recommendations may vary from those applicable to the use of your Child Restraint in a motor vehicle.

## Installing Callisto G 360 in an Aircraft

4. Adjust Child Restraint to the most upright position.
5. **ROUTE AIRCRAFT BELT** across the blue Belt Path over the **TOP** of the SafeLock Belt Tensioner.
6. **BUCKLE THE AIRCRAFT BELT.** Make sure the belt lies flat and is not twisted.
7. Pull the free end of the belt to tighten, then route the excess belt back across the blue Belt Path and over the **TOP** of the SafeLock Belt Tensioner.
8. Grab Base near Belt Path and check for tightness (pg. 56). Retighten if necessary.
9. If using your seat in **FORWARD-FACING MODE**, rotate back **TOWARD** aisle to avoid interference with aircraft components (i.e., interior panels, fixed armrests).
10. Lock Child Restraint into position.
11. Place child in seat and secure as shown on pgs. 61-67.

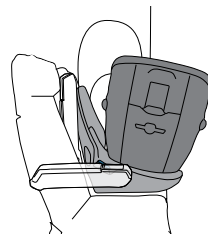
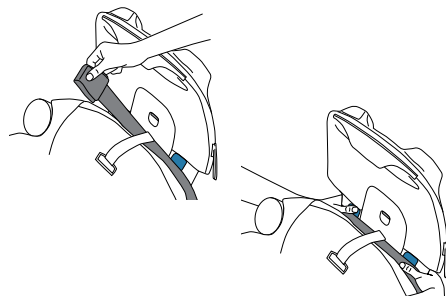

- Ensure that the seat is in the appropriate recline zone for proper use. Adjust the recline based on your child's weight.

If there is not enough space **REAR-FACING** to fully recline the Child Restraint, position the seat more upright for aircraft travel, making sure that the child reclines enough for their head to lie back comfortably and safely.

- Lower aircraft armrest back into position.
- Unfasten SensorSafe Chest Clip during Taxi, Takeoff, and Landing.

The SensorSafe Chest Clip may be refastened during flight or once the plane has safely landed and the use of electronic devices is permitted by the flight crew.

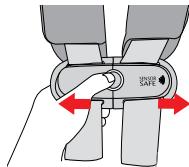
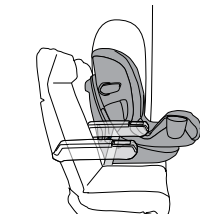

**IMPORTANT: NEVER** use bleach, household cleaners, or solvents. **DO NOT** use lubricants of any kind.

### Seat Cover, Shoulder Pads, Infant Insert Seat Pad & Head Pad, Buckle Pad

- Spot clean with a clean cloth using mild detergent and water.
- Machine wash with COLD water on a DELICATE cycle.
- Air Dry. **DO NOT** iron.

### Harness Straps

- Spot clean with a clean cloth using mild detergent and water.
- Air dry. **DO NOT** iron.

### Harness Buckle and Lower Anchor Connectors

- Spot clean with a clean cloth using mild detergent and water.
- Allow to dry thoroughly.
- Test by fastening and unfastening until an audible **CLICK** is heard. If there is no **CLICK**, repeat the cleaning procedure.

### Plastic Parts

- Wipe clean with a clean cloth using mild detergent and water.
- Cup Holders are top rack dishwasher safe.

## Safety Checklist

- ✓ Did you read and understand this Owner's Manual and all labels found on this Child Restraint?
- ✓ Does your child meet the Child Usage Guidelines for the mode being used (pgs. 8-12)?
- ✓ Is the Child Restraint in an approved vehicle seat location and positioned correctly (**REAR-FACING**, **FORWARD-FACING**, or **BOOSTER MODE**) for the child's weight?
- ✓ Is the seat recline angle correct according to the Recline Indicator?
- ✓ When used with the Internal Harness, is the Harness adjusted to the correct position for the size of the child? Is the Harness **AT or JUST BELOW** the child's shoulders when **REAR-FACING**, or **AT or JUST ABOVE** child's shoulders when **FORWARD-FACING**?  
Is the Harness snug around the child and secured properly with the Chest Clip positioned at armpit level?
- ✓ In **BOOSTER MODE**, is the Shoulder Belt positioned **AT or JUST ABOVE** the shoulders and does it pass through the Shoulder Belt Path? Does the Shoulder Belt cross midway between the child's shoulder and neck?  
Is the Lap Belt stretched low and snug across the child's hips within the Lower Belt Path and fastened into the buckle?
- ✓ Is the Tether Strap being used?
- ✓ Is today's date before the "Do Not Use After" date on the Child Restraint?
- ✓ Did you check for hot surfaces in sunny weather?
- ✓ If you answered YES to all of these questions, you are good to go. Please **DRIVE SAFELY!**

## Helpful Tips

**Pgs. 10, 40:** If used **REAR-FACING** in the most reclined position, some vehicles may require a **flatly folded towel** or **small blanket** under the foot of the Child Restraint to prevent small children's heads from falling forward.

Only items such as the flatly folded towel or small blanket are approved for use in this recline zone.

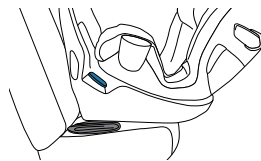

**Pg. 16:** If possible, adjust or remove the vehicle Headrest in the seat where the child restraint is to be installed, so that the back of the child restraint rests flat against the vehicle seat back.

**Pgs. 38, 63:** If the Headrest does not stay in the proper position to keep the Harness Straps **AT or JUST BELOW** or **AT or JUST ABOVE** the child's shoulders, pull up on the Headrest Height Adjustment Handle to raise the Headrest slightly past its intended position and let it drop down into place. Then pull up on the Headrest to ensure it is locked.

**Pgs. 48, 52, 56:** If Base still moves too much, you may need to try a different vehicle seat location and/or installation method, contact CYBEX Consumer Services, or visit the product FAQs by scanning the QR code shown here.



**CYBEX Consumer Services: 1-877-242-5676 or [info.us@cybex-online.com](mailto:info.us@cybex-online.com)**

Installing your Child Restraint correctly in your vehicle is extremely important for your child's safety. However, it is not always easy to do. **Statistics show that over 75% of Child Restraints are being used incorrectly!**

CYBEX has many trained CPSTs (Child Passenger Safety Technicians) on staff. Please contact us with any questions or concerns about installation, parts, maintenance, or warranty information.

- **Phone:** 1-877-242-5676 (toll-free)
- **E-mail:** [info.us@cybex-online.com](mailto:info.us@cybex-online.com)
- **Web:** [www.cybex-online.com](http://www.cybex-online.com)
- **Video Appointment:** <https://cybex.appointlet.com/>

When you contact us, please have the Model Number and Manufactured on Date ready so that we may help you efficiently. This information can be found on the registration card or underneath the Seat Cover where the seating surface and backrest meet.

You can also make sure your Callisto G 360 is installed correctly by selecting the "Find a Tech" link at <https://cert.safekids.org> and contacting a certified CPS Technician.

**Once your seat has reached its expiration date**, we recommend recycling the seat. Contact your local recycling center for the best way to dispose of your seat. We do not recommend giving or selling the seat to anyone, or simply putting it in the garbage.

## LIMITED WARRANTY

CYBEX warrants to the original consumer purchaser that this product will be free from defects in material and workmanship for two (2) years from the date of original purchase (the "Warranty Period"). During the Warranty Period, CYBEX, at its option, may repair or replace this product if it is found by the manufacturer to be defective in material or workmanship. CYBEX reserves the right to discontinue or change parts, fabrics, models, or products, or to substitute this product with a comparable model or product. To make a claim under this warranty, please contact us at [info.us@cybex-online.com](mailto:info.us@cybex-online.com), call us at 1-877-242-5676, or write to us at:

CYBEX Warranty  
Columbus Trading-Partners USA Inc.  
2915 Whitehall Park Drive, Suite 300  
Charlotte, NC 28273, USA

An original receipt is required to validate your warranty and shipping charges will be the responsibility of the original consumer purchaser. To expedite the processing of any future warranty claims and to verify the original date of purchase, please complete and mail the pre-addressed owner registration card within thirty (30) days of purchase.

## WARRANTY LIMITATIONS

This warranty does not cover the effects of normal wear and tear or damages resulting from negligence, modification, improper installation, accidents, misuse or abuse of this product. It is expressly agreed that the obligations of CYBEX and the original consumer purchaser's remedies under the limited warranty contained herein are exclusive and are strictly limited to the repair or replacement of the product. This limited warranty is



## **CYBEX Warranty**

---

conditional upon strict compliance with the provisions of the Owner's Manual. In no event will CYBEX or the dealer selling this product be liable to you for any damages, including incidental or consequential damages, arising out of the use or inability to use this product.

### **LIMITATION OF WARRANTIES AND STATE/PROVINCIAL LAW RIGHTS:**

The warranty and remedies as set forth above are exclusive and in lieu of all others, oral or written, express or implied. To the extent permitted by applicable law, any implied warranties, including implied warranties of merchantability and fitness for a particular purpose, are hereby disclaimed. Some states/provinces do not allow limitations as to how long an implied warranty lasts or the exclusion or limitation of incidental or consequential damages, so the above limitations may not apply to you. This warranty gives you specific legal rights, and you may have other rights, which vary from state/province to state/province. Neither CYBEX nor the dealer selling this product has authorized any person to create for it any other warranty, obligation, or liability in connection with this product.

CYBEX Industrial Limited  
Suite 1222, 12/F | Leighton Centre | 77 Leighton Road | Causeway Bay | Hong Kong  
[www.cybex-online.com](http://www.cybex-online.com)

Distributed in the United States by Columbus Trading-Partners USA Inc.  
2915 Whitehall Park Drive, Suite 300 | Charlotte, NC 28273 | USA  
Tel: 1-877-242-5676 | e-mail: [info.us@cybex-online.com](mailto:info.us@cybex-online.com) | [www.cybex-online.com](http://www.cybex-online.com)

© 2024 CYBEX Industrial Limited. All rights reserved. Printed in China.  
This product and its components are subject to change without notice. Patents pending.